

## DATA SHEET

<b>Mechanics</b>	
Opening	Manually
Locking	Manually
Blocking element	Solenoid
Mounting dimensions	Not Standard
<b>Electronics</b>	
Powersupply	9V ALKALINE battery
<b>Software</b>	
Codes	10 (6 digit)
Primary code	1
Secondary code	9
Battery low signal	yes
Manipulation protection	5 minute lockout after 4 consecutive wrong codes



## ePass Electronic Cam Lock

### EP80-40 Technical Manual



### CHARACTERISTICS

The ePass features a 6-digit Main code that can be changed by the user. With the main code up to 9 secondary codes can be activated and deleted. The lock secures with a solenoid that blocks the shaft movement. If a valid code has been entered, the lock electronics removes the blocking for 3 seconds and the handle can be moved into OPEN position. When moving the handle into LOCKED position the ePass automatically secures. The ePass is delivered with Main code only (1-2-3-4-5-6) and right handed (RH) opening. With a small adjustment (see page 2), the lock can be changed to left hand (LH) opening.

### DIMENSIONS

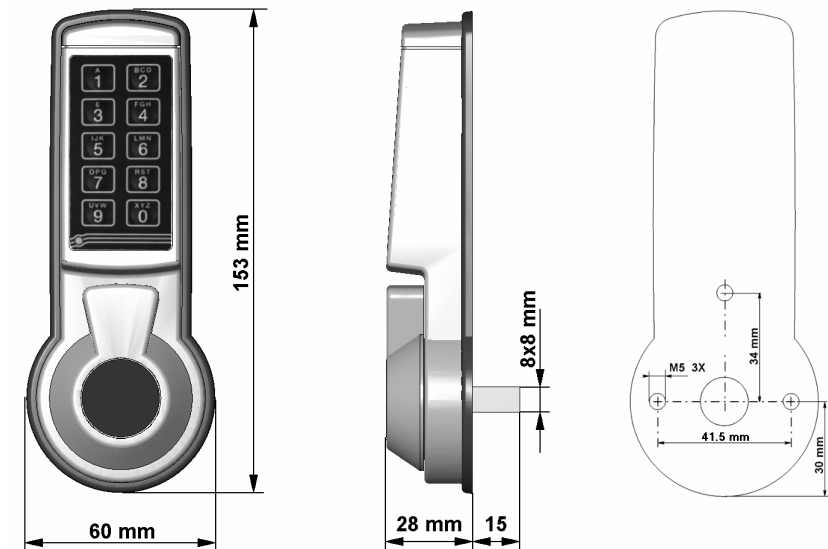

A longer shaft is sold separately (P/N EP90-10).

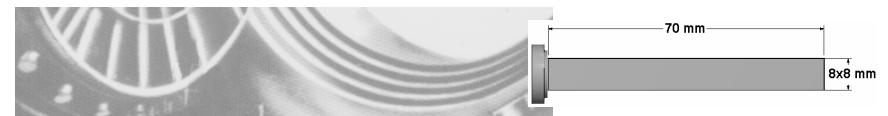

## MOUNTING INSTRUCTIONS

### 1. Preparation (may not be required)

Remove screw **A** (PH1 screwdriver) and take out plate **B** and the shaft **C**. Cut shaft to desired length or prepare otherwise depending on the type of installation. (Re-)Insert the shaft **C** so it fits on the half-moon shaped bar on the driver. Place the plate **B** back on the unit with the tapered screw hole to the outside. Affix with screw **A**.

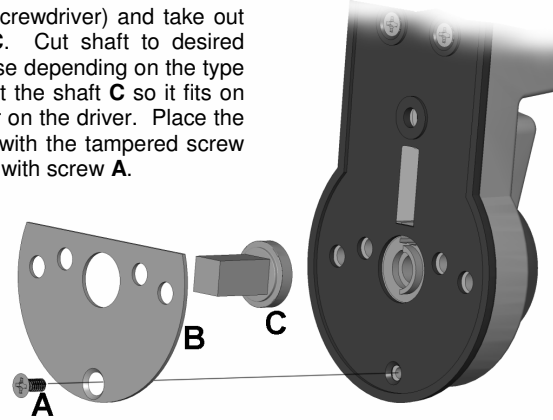

To change the unit from right handed (RH) opening to left handed (LH), unscrew the handle before applying the label. Pull the black disk off the spindle and flip it around. It should show "LH" engraved now. Push the disk back in place and affix the handle with the screw. The unit now opens by turning the handle towards left (counterclockwise).



### 2. Mounting

Mount the ePass housing with three (3) M5 screws (not included). Cover the screw in the handle with the label.



To insert a battery, slide the cap off the unit as shown. Connect one (1) battery to the battery clip. Only use fresh 9V-ALKALINE batteries from brand name manufacturers like DURACELL™. Align cap in the little track of the housing and slide back on.

### 3. FUNCTIONAL TEST (with door open)

Enter code (1,2,3,4,5,6) and turn handle towards OPEN position. The handle must be moving freely. Turn handle towards locked position. The lock must automatically secure.

Repeat functional test several times before locking the door.